

BRICK BUILDING  
GREENBUSH ASSOCIATES, LLC  
TAX LOT 155-6-1.226  
L. 348 P. 726  
AREA = 5.01 ACRES±  
LEASED BY RENSSELAER COUNTY  
INDUSTRIAL DEVELOPMENT AGENCY  
V. 7360 P. 215  
LEASED AREA = 5.04 ACRES±

LANDS N/F  
GREENBUSH ASSOCIATES, LLC  
TAX LOT 156-2-1.112  
L. 753 P. 18  
AREA = 6.12 ACRES±

LANDS N/F  
GREENBUSH ASSOCIATES, LLC  
TAX LOT 156-2-1.111  
L. 753 P. 18

LANDS N/F  
CENTRAL SCHOOL DISTRICT #1 OF  
THE TOWN OF EAST GREENBUSH  
TAX LOT 156-6-1  
L. 1190 P. 811

LANDS N/F  
CENTRAL SCHOOL DISTRICT #1 OF  
THE TOWN OF EAST GREENBUSH  
TAX LOT 156-6-1  
L. 1190 P. 811

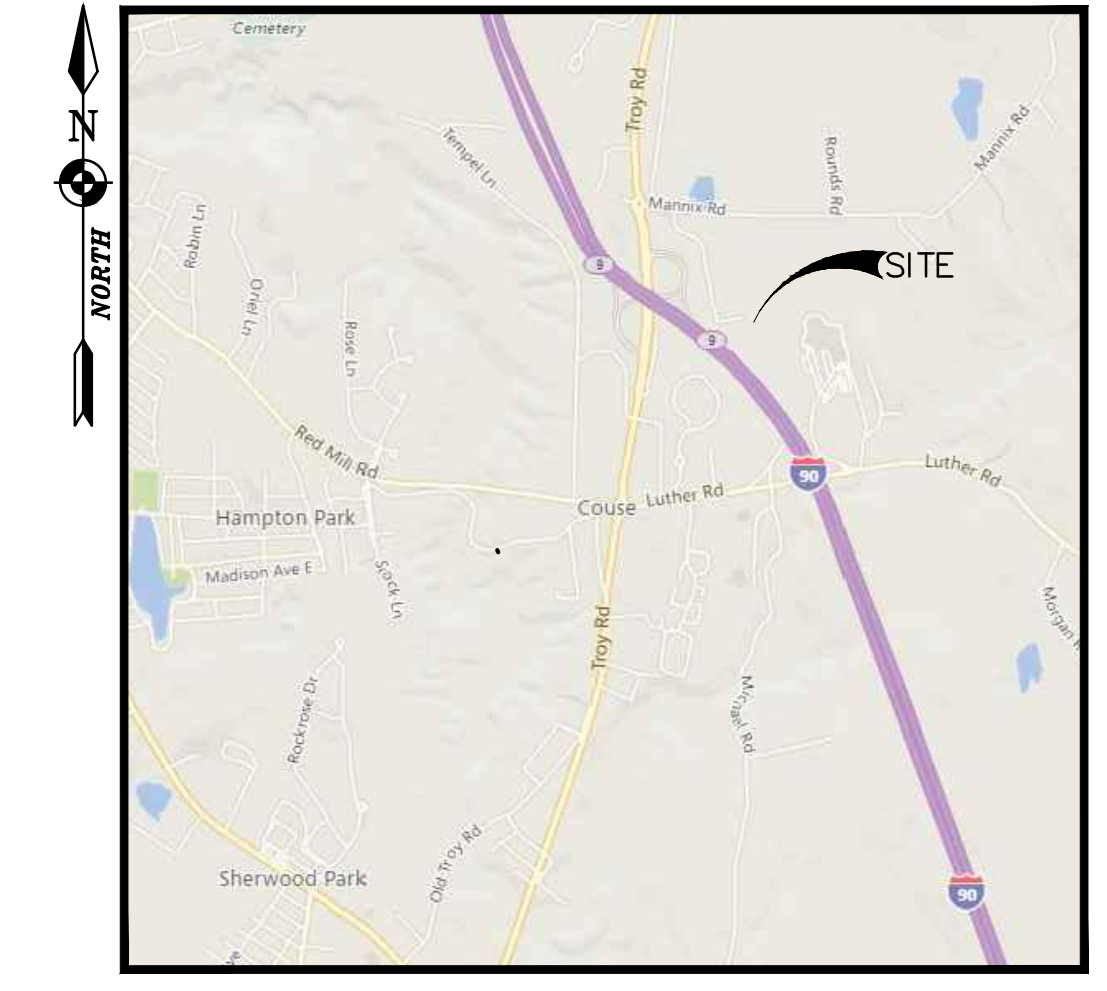

LOCATION MAP  
NOT TO SCALE

OWNER/APPLICANT:  
REGENERON PHARMACEUTICALS, INC.  
81 COLUMBIA TURNPIKE  
RENSSELAER, NY 12144  
ATTN: MR. MICHAEL BOAMAH

MAP REFERENCE:  
MAP TITLED ALTA/NSPS LAND TITLE SURVEY FOR  
REGENERON PHARMACEUTICALS, INC. BY COLLIER'S  
ENGINEERING & DESIGN, DATED 12/17/21, LAST  
REVISED 12/22/21.

- NOTES:**
- FENCE TO BE INSTALLED A MINIMUM 2' INSIDE OF PROPERTY LINE TO ALLOW FOR PROPER MAINTENANCE.
  - FOUR (4) GATES TO BE INSTALLED AT VARIOUS LOCATIONS ALONG FENCE LINE TO ALLOW FOR ACCESS AND MAINTENANCE (LOCATIONS SHOWN ARE APPROXIMATE).

1 SITE PLAN  
SCALE: 1"=40'

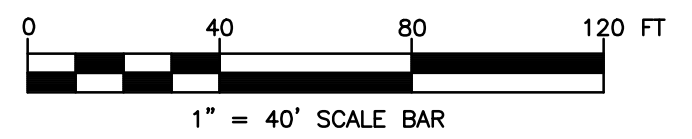

SITE PLAN APPROVAL BY PLANNING BOARD  
TOWN OF EAST GREENBUSH, NEW YORK  
CONDITIONS OR MODIFICATIONS \_\_\_\_\_

DATED \_\_\_\_\_  
APPROVED BY \_\_\_\_\_  
CHAIRMAN

STEVEN P. HART, P.E. #466039

REGENERON PHARMACEUTICALS  
PERIMETER FENCE AND WALKWAY  
30 TECH VALLEY DRIVE  
TOWN: EAST GREENBUSH COUNTY: RENSSELAER STATE: NEW YORK

**HART ENGINEERING**

1989 FERDINAND ROAD  
CASTLETON NY, 12033

Phone: (518) 479-4014  
Fax: (518) 477-8371

Draining Copyright © 2018  
NOTE: Unauthorized alteration of this map is a violation of section 2009 sub-section 1 of the New York State Education Law.  
Only copies from the original of this map bearing an embossed seal of the engineer and the embossed seal of the State of New York are considered to be true and valid copies.

NO.	DATE	DESCRIPTION	REVISED PER TOWN COMMENTS	
			DAH	SPH
1	6/1/22	ISSUED FOR REVIEW	DAH	SPH
2	6/6/22	REVISED PER TOWN COMMENTS	DAH	SPH

SITE PLAN

REGENERON PHARMACEUTICALS  
PERIMETER FENCE AND WALKWAY  
30 TECH VALLEY DRIVE  
TOWN: EAST GREENBUSH COUNTY: RENSSELAER STATE: NEW YORK

ENGINEER: STEVEN P. HART, P.E.  
DRAWN BY: DAH  
DATE ISSUED: APRIL 2022  
SCALE: AS SHOWN  
DRAWING NUMBER: C100

1 OF 1